

DISCOVER

THE EDGE OF INNOVATION

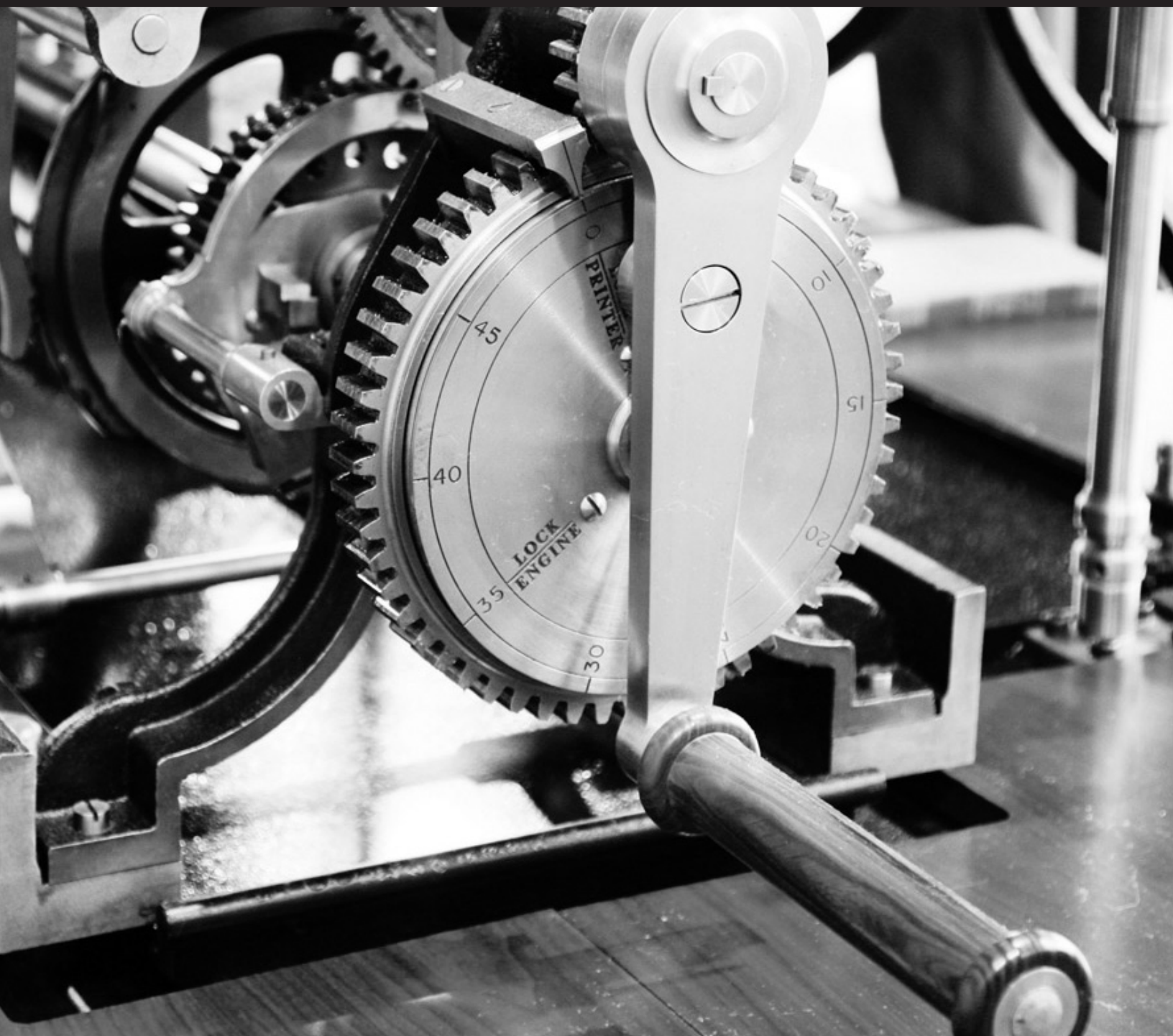

NW/MET 2012

SUNDAY

TIME	TITLE	PRESENTER	ROOM
12:00-1:30	Welcome, Opening Session & Luncheon		Whatcom
1:30-1:45	Break		
1:45-2:45	Concurrent Sessions		
	Using Student Interest Groups to Develop, Explore and Test New Technologies	Peter Wallis	San Juan
	The Future of Video Conferencing	Robert Clark	Sehome
	Lessons Learned: Planning and Building an Experimental Collaborative Computing and Technology Center	Monica Morillas	Fairhaven
2:45-3:00	Break		
3:00-4:00	Concurrent Sessions		
	Piloting the Canvas LMS	Renee Carney	San Juan
	Lecture Capture on a Budget: Providing Service without the Embedded Infrastructure	Stephanie Zimmerman	Sehome
	Digital Conversion and the Analog Sunset	Robert Schmitt	Fairhaven
4:00-4:15	Break		
4:15-5:15	Concurrent Sessions		
	LMS Next Steps	Scott Dennis & Connie Broughton	Fairhaven
	Simple Augmented Reality	Monica Marlo M-G	Sehome
	Lecture Capture Deployment for Higher Ed Applications	Shawn D'Sylva	San Juan
5:15-6:00	Break		
6:00-8:00	Dinner and Keynote Presentation	Jason Morris	Whatcom

MONDAY

7:30-8:30	Breakfast		Whatcom
8:30-9:30	Lightning Rounds		Whatcom
9:30-11:00	Vendor Expo & Discussion		Vendor Area
11:00-12:00	Concurrent Sessions		
	Is Your Technology Accessible? Issues and Implications for Higher Education	Terrill Thompson	Fairhaven
	The Student Technology Center Revisited	David Hamiter	San Juan
	The Path from LMS to Learning Platform	Jared Stein	Sehome
12:00-1:00	Lunch		Whatcom
1:15-2:15	Concurrent Sessions		
	Document Accessibility	Melany Budiman & Karen Sorensen	Sehome
	LMS Analytics – Student Academic Success	Randy Stamm	Fairhaven
	Live to Internet Video Production	Jeremy Engel	San Juan
2:15-2:30	Break		

MONDAY

TIME	TITLE	PRESENTER	ROOM
2:30-3:30	State Caucus Meetings		
	Washington Caucus		Fairhaven
	Oregon Caucus		Sehome
	Idaho Caucus		San Juan
	Other States and Provinces Caucus		Whatcom
3:35-4:00	Travel to Western Washington University		Meet in Hotel Lobby
4:00-5:30	Tour of Western Washington University		WWU
5:30-5:45	Travel to Spark Museum		
6:00-8:30	Dinner at the Spark Museum		1312 Bay St.

TUESDAY

7:30-8:30	Breakfast		Whatcom
8:30-9:15	Lightning Rounds: Mobile Topics		Whatcom
9:15-9:45	Discussion/Break		
9:45-10:45	Concurrent Sessions		
	The Mobile Learning Initiative at Boise State	Eric Orton & Bill Cottle	Fairhaven
	Academic Technology Roundtable: Faculty Leadership in Professional Development	Scott Christian & Sam Williams	Sehome
	Lecture Capture at Portland State University	Doug McCartney	San Juan
10:45-11:00	Break		
11:00-12:00	Concurrent Sessions		
	Camtasia Relay, Collaborate, and Bb Learn Voice: Choosing the Right Tool for the Job	Angela Wilson	San Juan
	Google is not God but She does have Nice Apps	Papa-Duke & Monica Marlo M-G	Fairhaven
	Teaching and Learning with iPad	Chuck Kenney	Sehome
12:00-2:00	Lunch and Caucus Reports		Whatcom

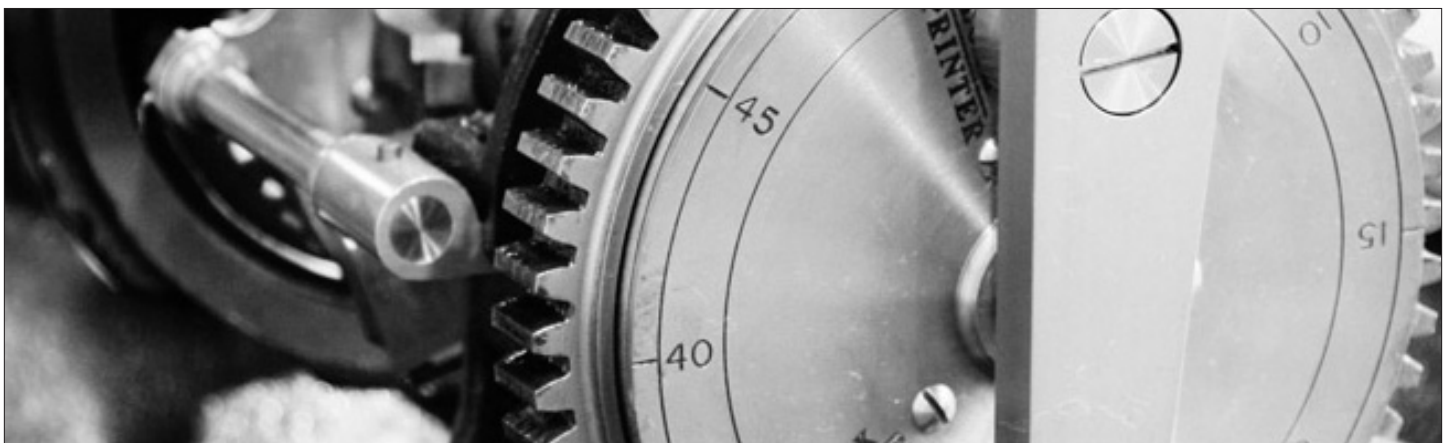



KEYNOTE



SUNDAY APRIL 22

Keynote: Creativity, Education and Augmented Reality

*Jason Morris - Associate Professor of Industrial Design
Western Washington University*

Prior to his career switch to academia, Professor Morris was a consulting product designer and a principal of the design firm *tool.* in Marblehead, Massachusetts. He has designed award winning products for clients such as *Kryptonite, Burton, Siemens, Ambient Devices, APC, Homax, Boston Scientific, MSI, Prudential, The First Years, and Waterworks.* Jason earned his Master's of Industrial Design from Pratt Institute and his Bachelor of Science in Mechanical Engineering from West Virginia University. He has been focusing his research on industrial design history, social purpose innovation, personal fabrication, and creativity.

#nwm12j

SESSIONS

SUNDAY APRIL 22

Using Student Interest Groups to Develop, Explore and Test New Technologies

*Peter Wallis - Instructional Technologist
IT, University of Washington*

No Teacher or Technologist has the time to explore, much less evaluate ever-increasing educational technologies. This talk will explore how students interested in improving their own grades and technologists interested in researching and evaluating new technologies for broader campus use can collaborate to improve education for all students.

#nwm12a

The Future of Video Conferencing

*Robert Clark - Manager ATUS Video Services
Academic Technology and User Services, Western Washington University*

This session will be an overview of technologies and trends in two-way point to point and multi point communications. We'll discuss the advantages of Polycomm, Skype, telepresence, etc.

#nwm12b

Lessons Learned: Planning and Building an Experimental Collaborative Computing and Technology Center

*Monica Morillas - Computer Classrooms and Labs Specialist
Portland State University*

See how Portland State University planned and implemented the construction of a new library learning ground, an updated computing center offering technology-specific furniture, assistive technology, and added power access. Also learn about the Sandbox, an experimental collaboration space offering a range of technologies such as wall-embedded LCD displays, touch-screen computers, floor-to-ceiling writeable wall surfaces and whiteboards, and modular and moveable seating and workspaces. Learn about the pitfalls, successes, and ongoing student feedback regarding the space.

#nwm12c

Piloting the Canvas LMS

Renee Carney - eLearning Manager

Katrina Fuller - Micro Biology Instructor

Lower Columbia College

Lower Columbia College's eLearning Manager, Renee Carney, will briefly explain LCC's process for choosing Canvas, a brief description of LCC's migration plan, provide feedback from instructors and students from their winter 2012 quarter pilot, and Katrina Fuller, an LCC Micro Biology Instructor, will present her successes and challenges from the pilot.

#nwm12d

Lecture Capture on a Budget: Providing Service without the Embedded Infrastructure

Stephanie Zimmerman - Director of Instructional Technology

Seattle University School of Law

SU Law provides an example of how innovative management and portable equipment can be used in place of expensive, embedded Lecture Capture and Video Conferencing systems. While not ideal, this flexible approach expands the features of one super-room to 18 classrooms with minimal staff and annual funding.

#nwm12e

Digital Conversion and the Analog Sunset

Robert Schmitt - Manager

Media Services, Portland Community College

At PCC we have just secured \$2.3 million and have begun to convert over 350 classrooms from analog to digital media over the next two years. We have adopted a two phase approach that will first replace all monitors, projectors, and screens. In phase two, we will replace all the control systems, inputs, signal processing, and cabling. This presentation will talk about our approach in planning and how we intend to attempt to incorporate more collaborative learning spaces and other newer technologies into the design.

#nwm12f

----- SESSION BREAK -----

LMS Next Steps

Scott Dennis - eLearning Professional Development Manager

Connie Broughton - Director eLearning and Open Education/eLearning

Education Division, Washington State Board, Community and Technical Colleges

In 2014 ANGEL, the LMS used by 28 Washington colleges and several universities will be discontinued. A statewide search process to replace ANGEL with participation by all colleges and universities will conclude shortly before the 2012 NWMET conference. Presenters will discuss lessons learned and the timeline and work plan ahead.

#nwm12g

Simple Augmented Reality

Monica Marlo M-G - Immedgineer

Distance Learning / Instructional Support, Portland Community College

This session will present simple augmented reality, the practice of geo-locating content, media and interactive experiences via Google Maps. By briefly presenting the selection criteria and best practices of place based learning and focusing on the mechanics and engagement of creating the experience, participants will leave this session with sample content that can be locally experienced, and step by step directions to create their own augmented campus tour.

#nwm12h

Lecture Capture Deployment for Higher Ed applications

Shawn D'Sylva - Regional Sales Manager

Crestron

The CaptureLiveHD™ system from Crestron® answers the call for a high-quality meeting and lecture capture solution that's simple enough for the entire faculty to use, and affordable enough for wide-scale deployment across any sized campus or corporate enterprise. CaptureLiveHD delivers a complete end-to-end solution for scheduling, recording, and online delivery of captured content. Flexible enough to fit any education, government, or corporate work-flow model, CaptureLiveHD translates to greater usage of resources and a more effective education experience while minimizing support overhead.

#nwm12i

MONDAY APRIL 23

Is Your Technology Accessible? Issues and Implications for Higher Education

Terrill Thompson - Technology Accessibility Specialist

UW Information Technology, University of Washington

This session will examine the current state of information technology accessibility in higher education. It will include an overview of accessibility issues and recent legal developments, and will identify strategies and best practices for ensuring our technologies are accessible to all students, faculty, staff, and visitors, including those with disabilities.

#nwmet12l

The Student Technology Center Revisited

David Hamiter - Supervisor of WWU Student Technology Center

Academic Technology and User Services, Western Washington University

The Student Technology Center (STC) at Western Washington University was founded in 2004 in a basement with a few resources. It now exists as a member of Western Washington University's Learning Commons on the 2nd floor of the Library. The STC has seen a lot of change of the last eight years. In this presentation we will share some of our experiences with you.

#nwmet12m

The Path from LMS to Learning Platform

Jared Stein - Sales Engineer

Instructure

Learning management systems have traditionally provided a tool set that accommodates essential teaching and learning tasks at a rudimentary level, but have failed to translate many nuanced or innovative ideas to the online environment. In this session we'll explore a number of case studies and examples from schools around the country that demonstrate how new technology in Instructure's Canvas platform can amplify fidelity, bring humanness to online courses, and encourage reflection and analysis that supports new approaches to online and blended education. We'll also look at how the transition from monolithic LMS toward an open, interoperable learning platform will allow educators and designers to bridge formal, classroom instruction to the informal, lifelong learning that is critical to success.

#nwmet12n

----- SESSION BREAK

Document Accessibility

Melany Budiman & Karen Sorensen - Instructional Technology Specialists

Instructional Support / Distance Learning, Portland Community College

This session will teach you how to make your web pages, PDFs, Microsoft Word documents and Microsoft PowerPoints presentations accessible to students with disabilities. Bring your laptop with Microsoft Office for some hands-on learning.

#nwmet12o

LMS Analytics – Student Academic Success

Randy Stamm - eLearning Coordinator

Instructional Technology Resource Center, Idaho State University

Find out how to evaluate the data found in your Learning Management Systems (LMS) to predict potential problems with student academic success. Academic analytic theoretical information will be presented to demonstrate how institutions can move beyond collecting and reporting to predicting and improving learner success.

#nwmet12p

Live to Internet Video Production

Jeremy Engel - Territory Sales Manager

Roland Systems Group

This presentation will cover topics that include: SD & HD streaming formats, aspect ratios, mobile and fixed streaming solutions and service options.

#nwmet12q

TUESDAY APRIL 24

The Mobile Learning Initiative at Boise State

Eric Orton & Bill Cottle - Instructional Designers

Academic Technologies, Boise State University

This presentation covers current projects and findings from Boise State's Mobile Learning Initiative. We will discuss the mLearning Scholars program (14 faculty members teaching classes where every student has a mobile device). We will also discuss plans for infusing mobile learning throughout an entire academic program, and our plans for supporting this program's development and implementation.

#nwmet12s

Academic Technology Roundtable: Faculty Leadership in Professional Development

Scott Christian - Director of Academic Technology Services

Sam Williams - Academic Technology Specialist/Trainer

Information Services, University of Portland

Last spring, the Academic Technology Services team worked collaboratively with the Deans for all of the academic units: arts and science, business, education, nursing, engineering and the graduate schools to conduct a competitive call for proposals. Faculty across the university submitted proposals for innovative projects involving the wise integration of academic technology. Successful applicants, (13 faculty conducting 10 innovation projects) serve on the UP Academic Technology Roundtable, a leadership cadre and professional learning community. The Academic Technology Roundtable will collaboratively research emerging and existing technology tools and plan for the implementation of academic technology for the UP community. Through the implementation of focused classroom technology projects, and the systematic analysis of student achievement, this group will investigate innovative teaching practice through the wise integration of technology. This presentation will feature short glimpses of the projects and a discussion about faculty leadership in academic technology, including e-portfolios, digital marketing, podcasts in Biology, analysis of online discourse, virtual communities in nursing, to name a few."

#nwmet12t

Camtasia Relay, Collaborate, and BbLearn Voice: Choosing the Right Tool for the Job

Angela Wilson - Instructional Designer/Trainer

Distance Learning, Lewis-Clark State College

A brief overview of LCSC's use of Camtasia Relay and iTunes U, upcoming plans for Collaborate, and plans for promoting the use of Voice Tools in online language courses. Choose the best tool for the job to enhance the online learning experience.

#nwmet12u

----- SESSION BREAK

Lecture Capture at Portland State University

Doug McCartney - Director Instructional Technology Services

Portland State University

This presentation will be an overview of the need for and implementation of lecture capture hardware and software on the PSU campus. The presentation will also cover the value that lecture capture has added for both the students taking and the faculty delivering the courses, as well as some of the challenges that had to be overcome for implementation, which include faculty acceptance and campus wide scalability.

#nwmet12v

Google is not God but She does have nice apps

Papa-Duke - Media Dave

Monica Marlo M-G - Immedgineer

Walla Walla and Portland Community Colleges

NWNET uses great looking Google Apps to draw whistles of approval but alas and alack they are going unobserved and underappreciated. Bring your gizmos, gadgets, pads, phones and pda's to this session and get in on these glamorous apps.

#nwmet12w

Teaching and Learning with iPad

Chuck Kenney - Account Executive

Apple, Inc.

iPad -- a whole new category of technology device -- has arrived on campus and is poised to change the higher education landscape in exciting new ways. The iPad is great for much more than just watching movies, checking email and browsing the web. It's a powerful content creation tool that makes possible new ways to reach students and streamline teaching practices. At this presentation you'll see how iPad can open students to an exciting new world of learning content through electronic books, applications and iTunes U. You'll also preview tools and workflows that faculty can use to enhance teaching both inside and outside of the traditional classroom. See how iPad can transform the way you and your students acquire, interact with and use knowledge through this latest generation of mobile technology solutions.

#nwmet12x

LIGHTNING ROUNDS

#nwmet12k

MONDAY APRIL 23

Rubrics in Moodle

Randy Stamm- eLearning Coordinator

Instructional Technology Resources Center, Idaho State University

Captioning Video in 5 Minutes

Terrill Thompson - Technology Accessibility Specialist

UW Information Technology, Univeristy of Washington

Faculty Development in the JIT Digital Age

Colleen Carmean & Beckie Etheridge

University of Washington, Tacoma

Quality Matters – First Steps to a Team Approach for Instructional Design Support

Edward Bachmann - ELearning Director

Pierce College

A Canvas Pilot at Lower Columbia College

Renee Carney - eLearning Manager

Lower Columbia College

The Benefits of Collaboration With English 420

David Hamiter - Supervisor of WWU Student Technology Center

Academic Technology and User Services, Western Washington University

Overview of an Assistive Technology Resource Center as a Resource in a College of Education

Linda Schleaf, M.Ed. - Ershig Assistive Technology Resource Center

Woodring College of Education, Western Washington University

Distributive Learning in Refugee Settings

Mark Beattie, Ph.D. - Director of Distributed Learning

School of Professional Studie, Gonzaga University

ThorZone: Climate Mapping Tool

*Justina Brown, M.Ed. - Instructional & Multimedia Designer
Center for Instructional Innovation & Assessment, Western Washington University*

Who’s the slacker? Evaluating Team Member Efficacy

*Justina Brown, M.Ed. - Instructional & Multimedia Designer
Center for Instructional Innovation & Assessment, Western Washington University*

TUESDAY APRIL 24

The iPad as a Laptop Replacement

*Kevin Dixey - Application Specialist
Academic Technology and User Services, Western Washington University*

Western Mobile Apps Roundup

*Jennifer Dixey – Web Application Support
Academic Technology and User Services, Western Washington University*

Coffee Shop Technology

*Chris Powell - Information Technology Specialist
Academic Technology and User Services, Western Washington University*

Fuse for Video Capture and Hosting

*Peter Agras - Instructional Designer
Academic Technology and User Services, Western Washington University*

But Wait ... There’s More! Outfit Your iOS Device with Teaching Apps for Just \$19.99

*Eric Orton & Bill Cottle - Instructional Designers
Boise Sate University*

Second Floor Room Layout

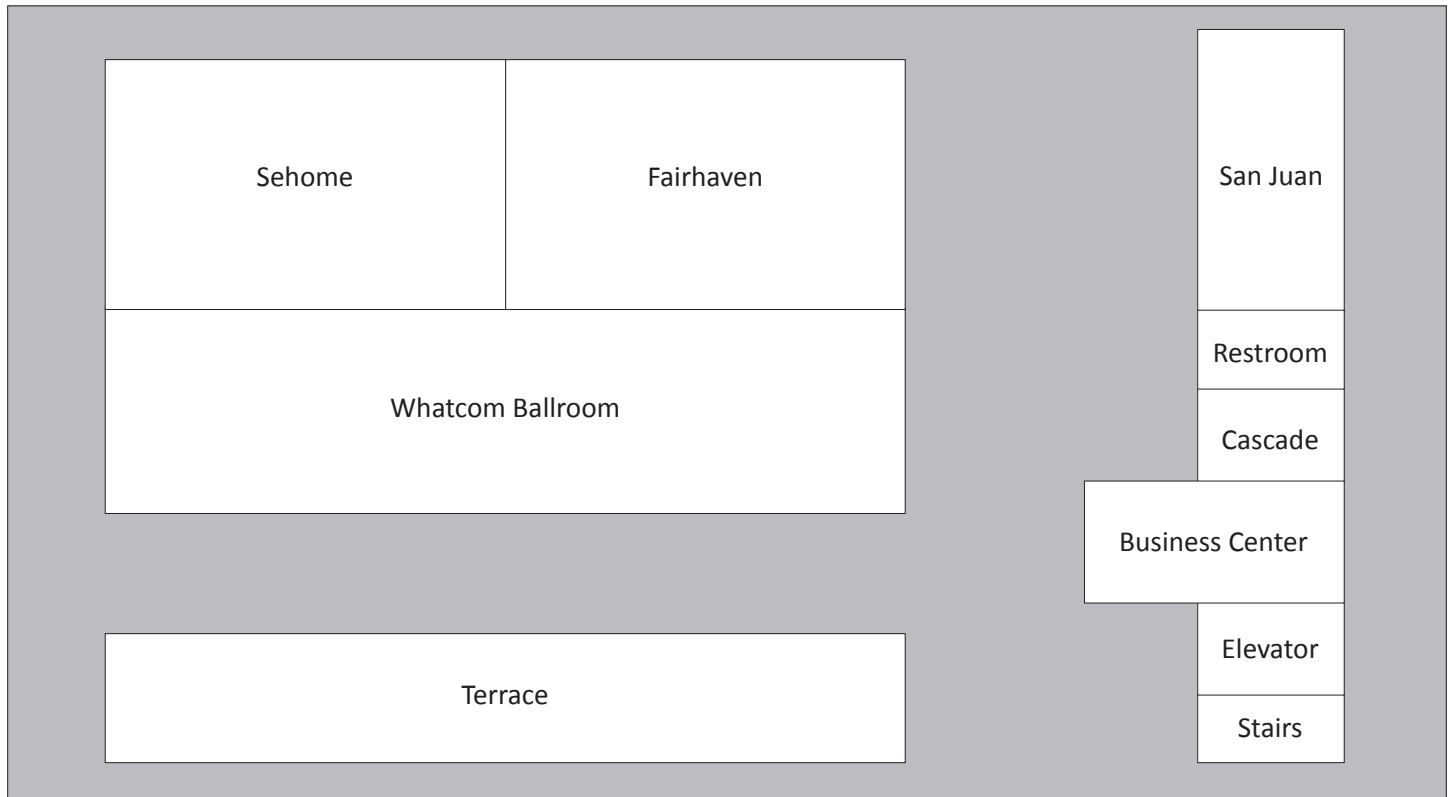



NW/MET

Northwest College and University Council for Management of Educational Technology

NWMET is an organization of Educational Technology units at universities and colleges in the Pacific Northwest region of the United States and in western Canada. NWMET has two main objectives: to develop an identity among professionals managing media services, faculty and instructional development, media production, and other educational technology services in higher education institutions in the Northwest, to improve the process of managing faculty and instructional support programs.

<http://www.nwmet.org>

NW/MET would like to thank the following corporate sponsors:

Apple Inc., Crestron, Echo360, ELMO, Hitachi America Ltd, Instructure, KlassTech, Roland Systems Group, Sign Up Digital, Troxell Communications

The NWMET 2012 Program Chair, John Farquhar, would like to thank

the following individuals for their support:

Equipment Support: Gary Malick, Technical Support: Ed Bachmann, Video Support: Robert Clark,
Transportation: Susan Brown, Graphic Design: Kevin Dixey, Social Media: JJ Johnson



And Western Washinton University:

for providing equipment for the event and hosting a tour of campus.

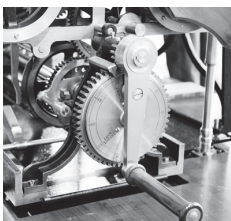

Cover photo: "Babbage Difference Engine (Crank at the output end 2)," © 2010 Magnus Manske, used under a Creative Commons Attribution-ShareAlike license: <http://creativecommons.org/licenses/by-sa/3.0/>

The Difference Engine was an advanced automatic mechanical calculator for the tabulation of polynomial functions envisioned by Charles Babbage as a way of producing error free tables the Difference Engine was built in 1822 and later completed by the London Museum in 1991.